

1 Block A2 - Level 0,1 & 2 - Open Plan
1 : 100

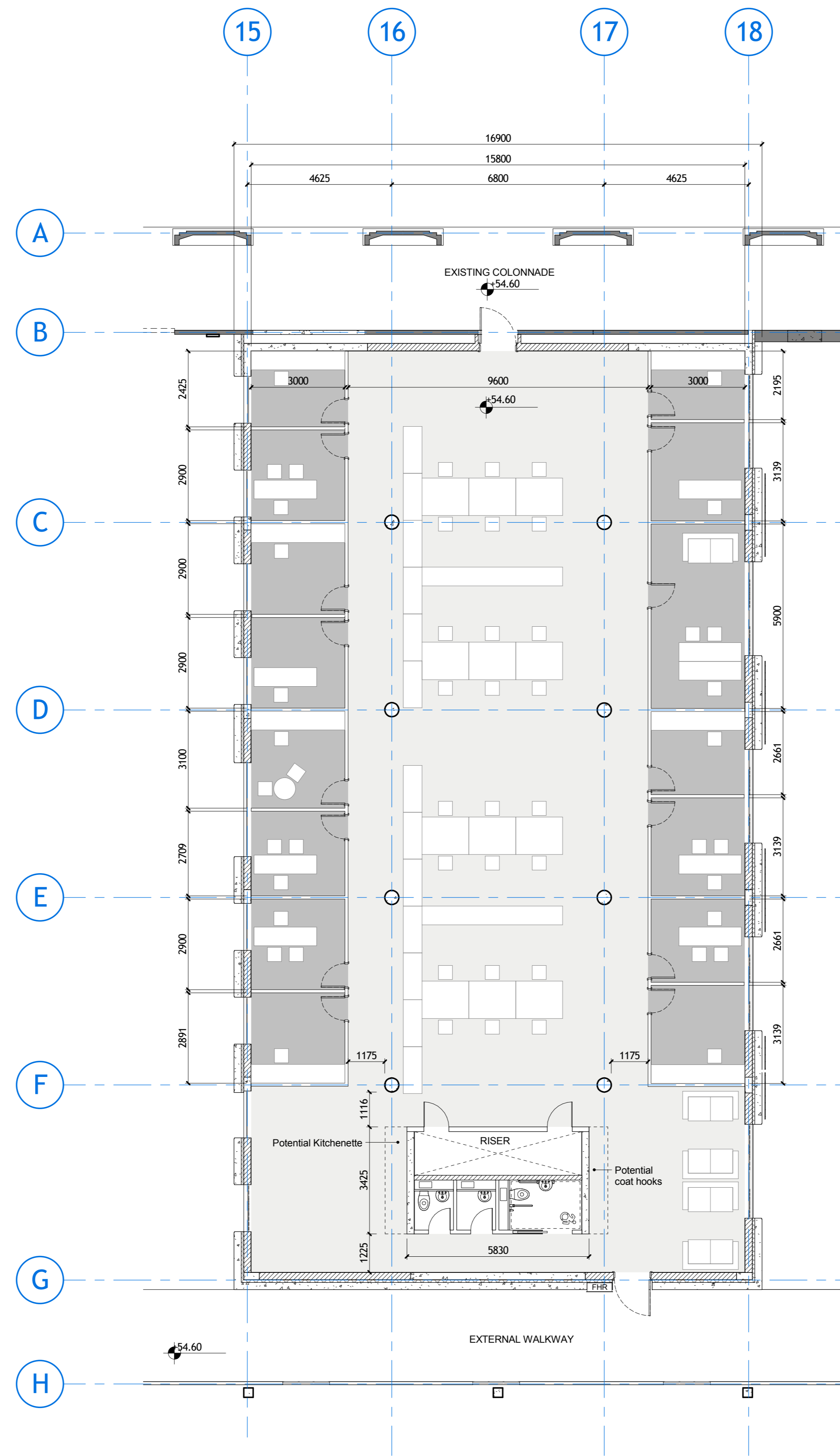

3 Block A2 - Level 0,1 & 2 - Small Cubicle
1 : 100

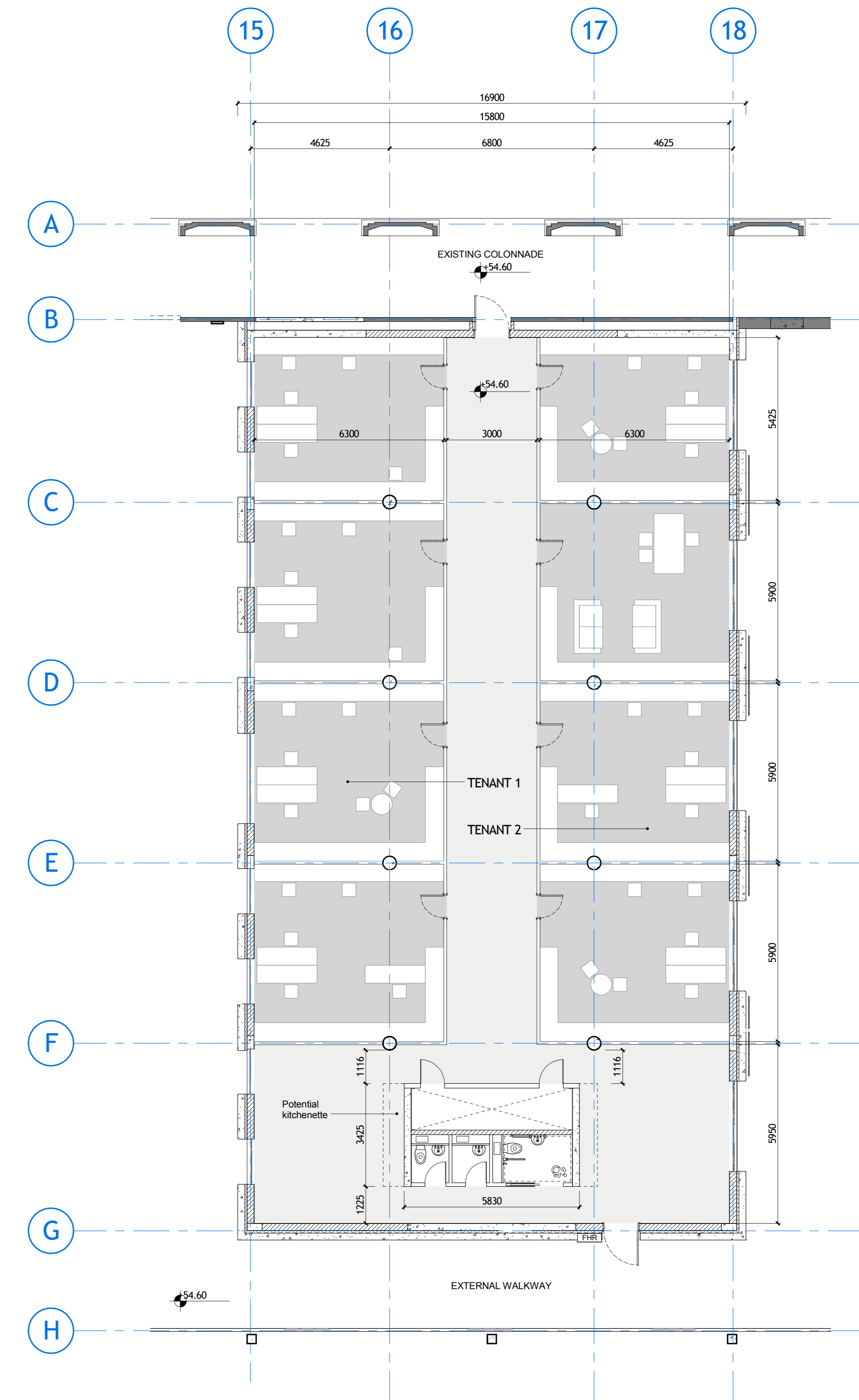

2 Block A2 - Level 0,1 & 2 - Large Cubicle or Split Tenancy
1 : 100

DO NOT SCALE
THIS DRAWING IS © IAN RITCHIE ARCHITECTS LTD
Dimensions to be verified on site.
Figural dimensions to take preference to these scaled.
All discrepancies to be clarified with the project Architect.
Unless otherwise stated all levels to be A.S.L.
This drawing is the property of Ian Ritchie Architects Ltd, and is
issued on the condition it not reproduced, stored or disclosed
to any unauthorised person, either wholly or in part without
written consent.

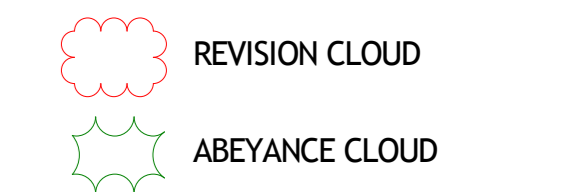
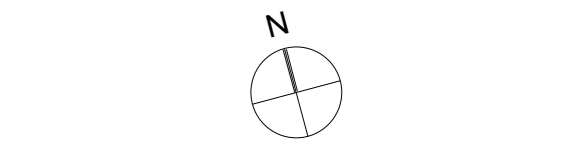
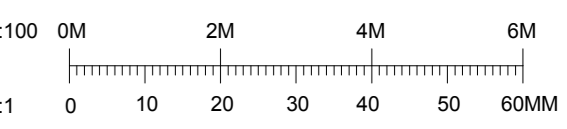

01.07.2016	TOD	KS	IR	Stage 4 - First Issue
Rev.	Date	By	CA	Description

Job Title
FARSONS BUSINESS PARK

Drawing Title
**Block A2 - Plan
Fit-out Options -
Levels 0,1 & 2**

IAN RITCHIE ARCHITECTS Ltd
110 Three Colt Street London E14 8AZ
Tel: (44) 2073381100 Fax: (44) 2073381199

TBA periti
43, Main Street, Balzan BZN 1259, Malta
Tel: (356) 21498332 Fax: (356) 21498334

Status **STAGE 4**

Scale 1 : 100@A0 Date 01.07.2016

Drawn TOD	Checked KS	Approved IR
Job No. 671	Drawing No. IRAL-A2-39-1001	Rev.